

PNEUMATIC CYLINDER VALVE

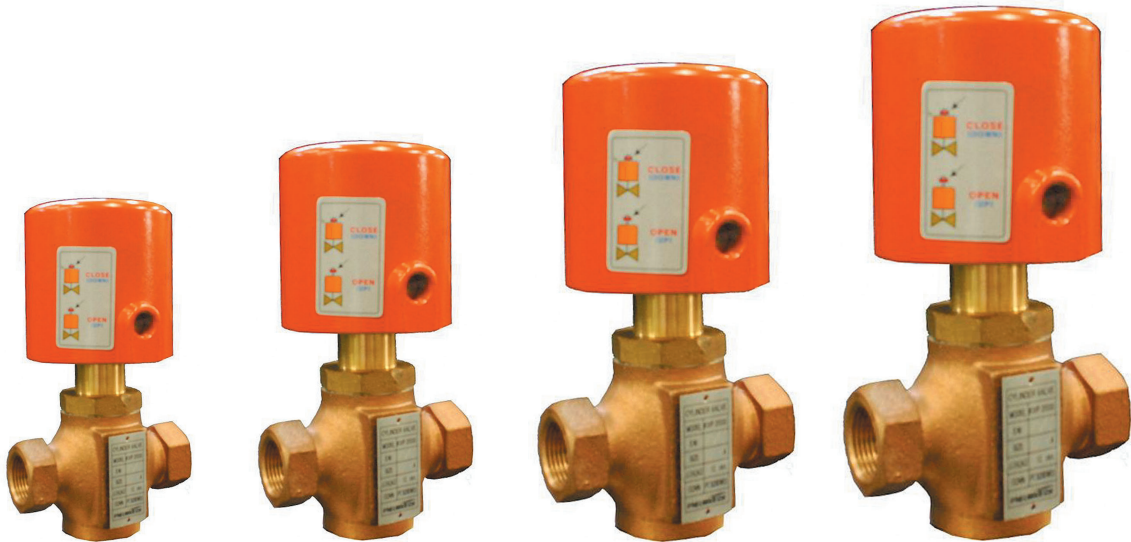

KVP-2000

특징 / Features

- 소형, 경량, 가격저렴, 최고품질
(Small, Compact, Low Price & Good Quality)
- 복잡하고 좁은 공간에 쉽게 착용
(Application for Complicate place, Narrow space)

SPECIFICATIONS

- 적용(Application) : Food, Cloth & Dyeing, Environment, Mechanics, Air dryer system, etc.
- 적용유체(Application Fluid) : Water, Air, Steam, Oil, etc.
- 재질(Materials) : Body & Trim – Bronze
Seat – Glass 15% Teflon
(User가 요구시에는 Body 재질 – SUS304 or SUS316 제작공급 가능)
- 사용유체온도 (Temperature) : Max. 180°C
- 주위온도 (Ambient Temperature) : -20 ~ 80°C
- 사용압력 (Operating Pressure) : 8kg/cm²
- 테스트압력 (Test Pressure) : 15kg/cm²
- 연결(End Connection) : PT Screwed
- Air 투입시 Open (Fail to Close Type)
- 밸브구경 : 15A, 20A, 25A, 32A, 40A, 50A

DIMENSIONS

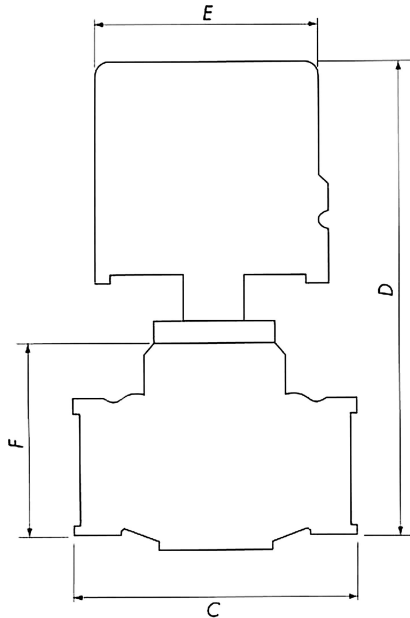

SIZE(A)	C	D	E	F
15A	100	175	80	67
20A	100	180	80	68
25A	105	180	80	70
32A	105	185	80	74
40A	142	230	100	92
50A	168	240	100	105

5-11

MECHANICAL DATA

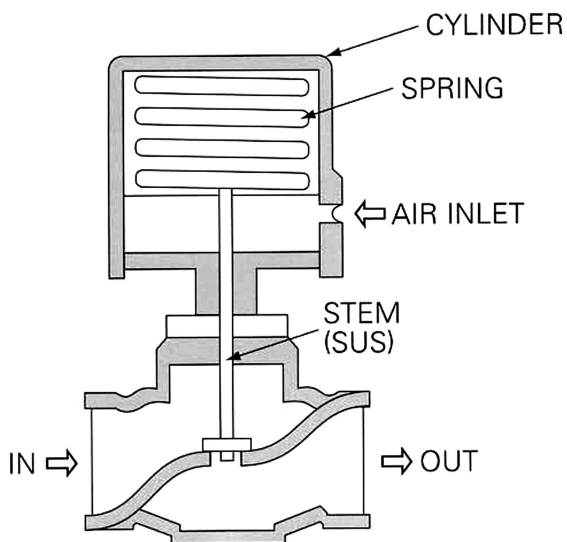

- 실린더 내부에 스프링 내장 (Fail to Close)
- 재질(STEM) : SUS 304